

Electone. **STAGEA** ELS-03G, ELS-03X, ELS-03XR, ELS-03XF

Firmware Update Guide

Confirming the Electone version

Before starting the firmware update, make sure to confirm the version of your Electone.

1. Press the **DISPLAY SELECT [UTILITY]** button to call up the **UTILITY** display.

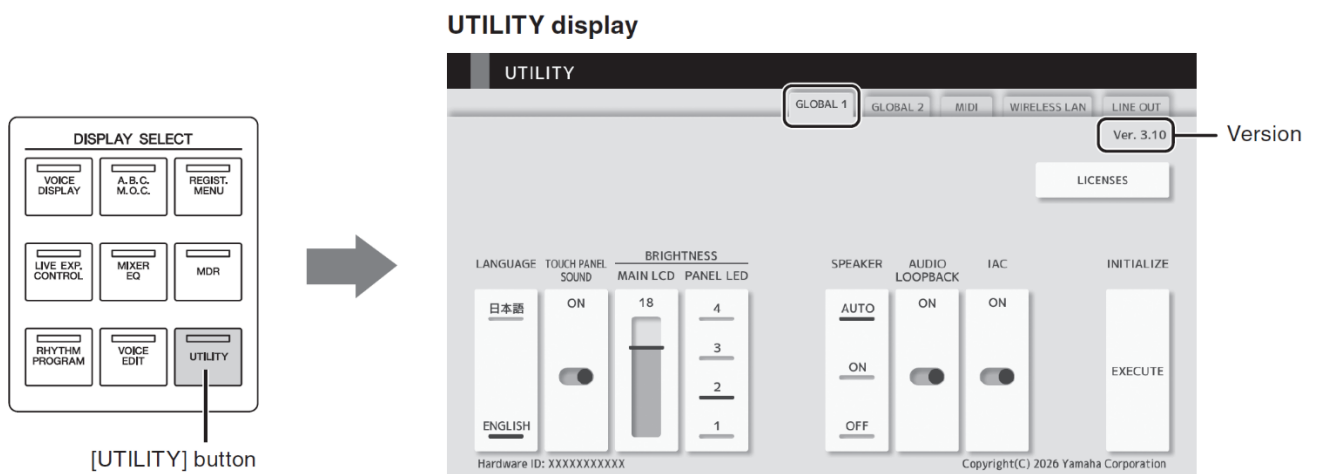

The firmware version can be confirmed at the upper right of the display on the [GLOBAL 1] tab.

Preparing the firmware update file

1. Prepare a **USB flash drive with sufficient free space for the firmware update file.**

NOTICE

Please make sure to use only USB flash drives that are compatible with the Electone, as listed in the Compatible USB Device List.

For a list of the compatible USB devices, access the Yamaha website below:

Yamaha Downloads <https://download.yamaha.com/>

2. **Download the firmware update file to your computer, and then copy it to the root directory (top level) of the USB flash drive.**

Extract the downloaded file, and then copy the extracted file (ELS-03SETUP.PRG) to the root directory of the USB flash drive.

Updating the firmware

NOTICE

- Make sure that you do not disconnect the USB flash drive, or turn off the power during the operation. Doing so may result in damage to the Electone.
- If any buttons other than the one being operated are pressed, the installation screen may not appear. Make sure that no buttons on the panel are pressed.

If there are any difficulties or problems that arise during the firmware update, refer to the [Troubleshooting](#) section on page 4.

1. Turn off the power.

2. Make sure that no USB devices are connected to the Electone's USB TO DEVICE terminals.

The Electone features three USB TO DEVICE terminals. Make sure that no USB flash drives or other USB devices are connected to any of them.

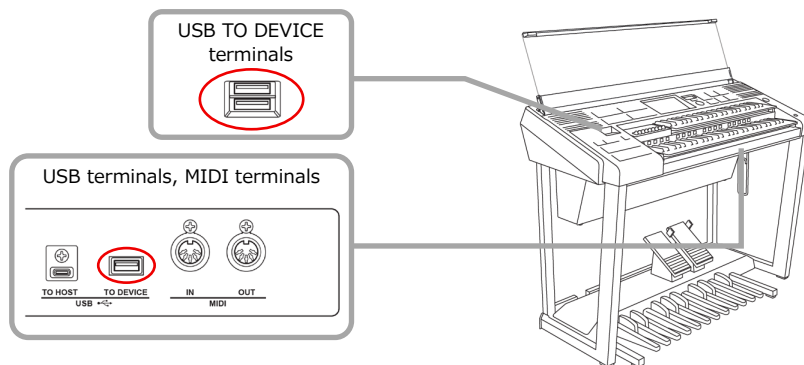

3. Connect the USB flash drive with the firmware file to the USB TO DEVICE terminals.

You can connect the USB flash drive to any of the USB TO DEVICE terminals.

4. While holding down the RHYTHM CONTROL [START] button, press the [⏻] (Standby/On) switch to turn on the power.

Keep holding down the [START] button until the following message appears on the display (about 6 seconds).

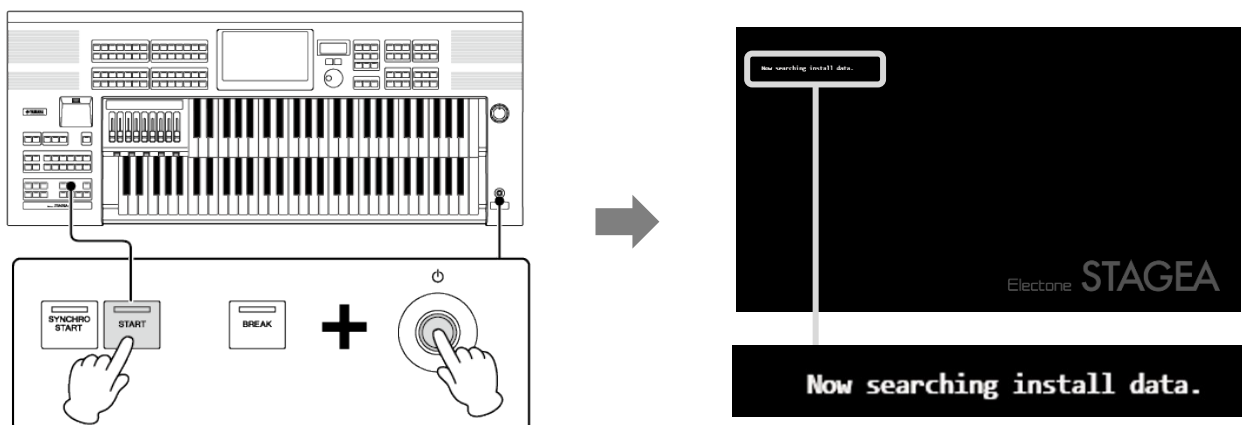

5. After the loading screen is displayed, the version of the program to be installed appears on the display.

The time required for the version to appear varies depending on the firmware update file.

6. Check the version to be installed on the display, and then press the RHYTHM CONTROL [START] button to start the installation.



NOTICE

Make sure that you do not disconnect the USB flash drive, or turn off the power during the operation. Doing so may result in damage to the Electone.

7. When the following message appears on the display, the installation is complete.
(V3.10)

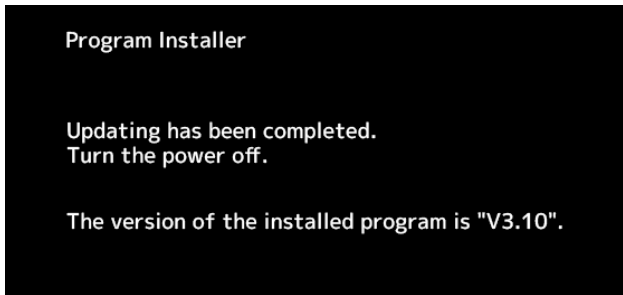

8. Turn off the Electone and disconnect the USB flash drive.

Press the DISPLAY SELECT [UTILITY] button to call up the UTILITY display. Select the [GLOBAL 1] tab, and then check the firmware version shown at the upper right of the display (see [page 1](#)).

Delete the firmware update file from the USB flash drive using your computer.

Troubleshooting

- **The power was turned off, or the USB flash drive was disconnected during the firmware update.**

You will need to install the firmware again. Go back to the first step and then follow all the steps to the finish.

- **An error message is displayed and the installation aborts.**

Check the following points.

- Is the USB flash drive connected correctly?
- Did you extract (unzip) the downloaded file before copying it to the USB flash drive?
- Is the update file located in the root (top level) of the USB flash drive?
- Is the version of the data to be installed correct?
- Did you rename the firmware update file? (The firmware update file must not be renamed.)
- Are you using a USB flash drive supported by the Electone?
- Is the data on the USB flash drive corrupt, or is the USB flash drive itself defective? Try installing again using a different USB flash drive.